

Elizabeth Court
****Hampton Road**
Teddington
TW11 0JS

£305,000

ChaseBuchanan



Elizabeth Court

Approx. Gross Internal Area
44 Sq M - 469 Sq Ft

ChaseBuchanan

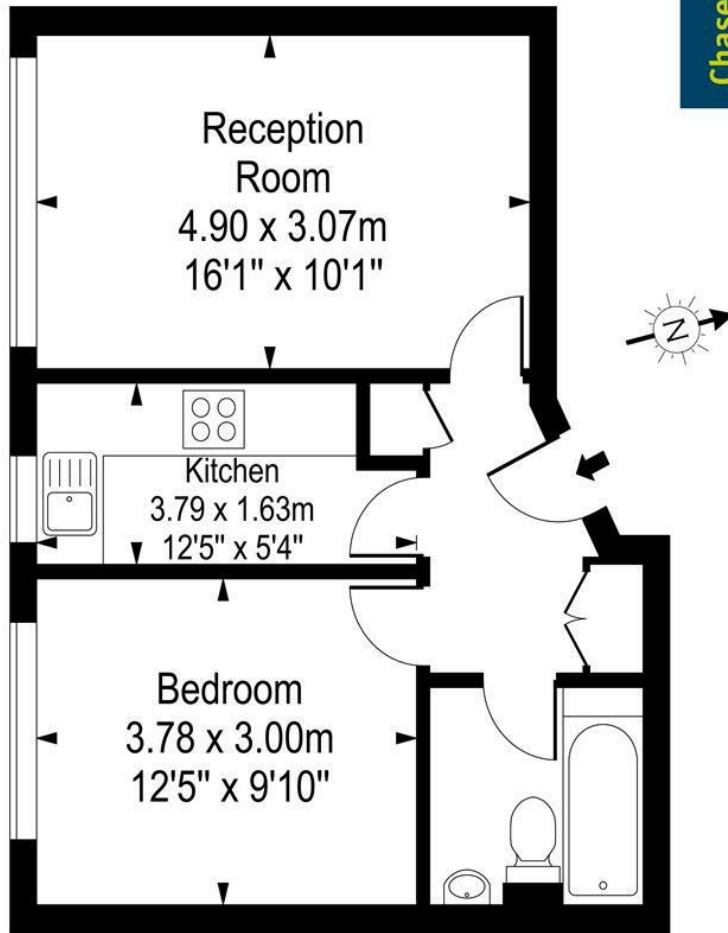

First Floor

Every attempt is made to assure accuracy, however measurements are approximate and for illustrative purposes only. Not to scale.
Floor plan by www.frameworkphotos.co.uk

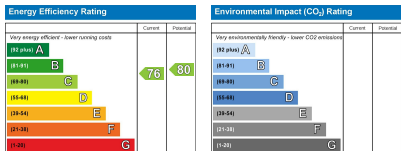

Care has been taken in the preparation of these particulars, however, their accuracy is not guaranteed and they do not form part of any contract. Measurements stated must be considered maximum.

- Viewings accompanied by Chase Buchanan
- One double bedroom
- Long lease
- Popular location
- No onward chain
- Walking distance to station

This is a one double bedroom, purpose built, first floor flat located in a popular block, just opposite Royal Bushy Park and close to Teddington High Street.

The property has a modern kitchen and bathroom, bright living room and is offered to the market with no onward chain.

Close by there are many boutique shops, restaurants and the amenities of Teddington and Twickenham, including the David Lloyd leisure centre and The prestigious Lensbury Club. Locally there are excellent transport links, with Teddington train station offering direct access to London Waterloo and regular buses into both Kingston and Richmond town centres.

For more information or to book a viewing, please contact:

020 8977 1166

ChaseBuchanan

43 High Street, Teddington, TW11 8HB